

**SPECIFICATIONS:**

The Neonatal Intensive Care Unit shall be an Amico **Noble** Series.

The N.I.C.U. system shall use one or more horizontal service fascia to locate services such as medical gas, electrical and communications.

The horizontal and vertical accessory channels shall be a complete part of the assembly and shall be flush with the front of the unit.

The vertical service chase, if required, shall provide concealment of electrical and medical gas piping. Accessory tracks are on the front of the vertical chase. Monitor channel, if required, can be mounted directly to the vertical chase.

The N.I.C.U. system removable access panels will be finished with high-pressure plastic laminate on the outside face. A wide variety of colors are available from Formica and Wilson Art.



- Custom designed to each area and different levels of acuity
- Different configurations available:
  - back to back
  - stand alone
  - against a wall
- Services installed for single point connection
- Available in 6-8 weeks from final approved drawings
- Custom Designed to fit any location and acuity level
- Can accommodate numerous quantity of services
- Flexibility in size and location of equipment storage cart cove
- Wide variety of Amico accessories can mount to vertical and horizontal accessory tracks

**PROJECT**

---



---



---

# DIMENSIONS

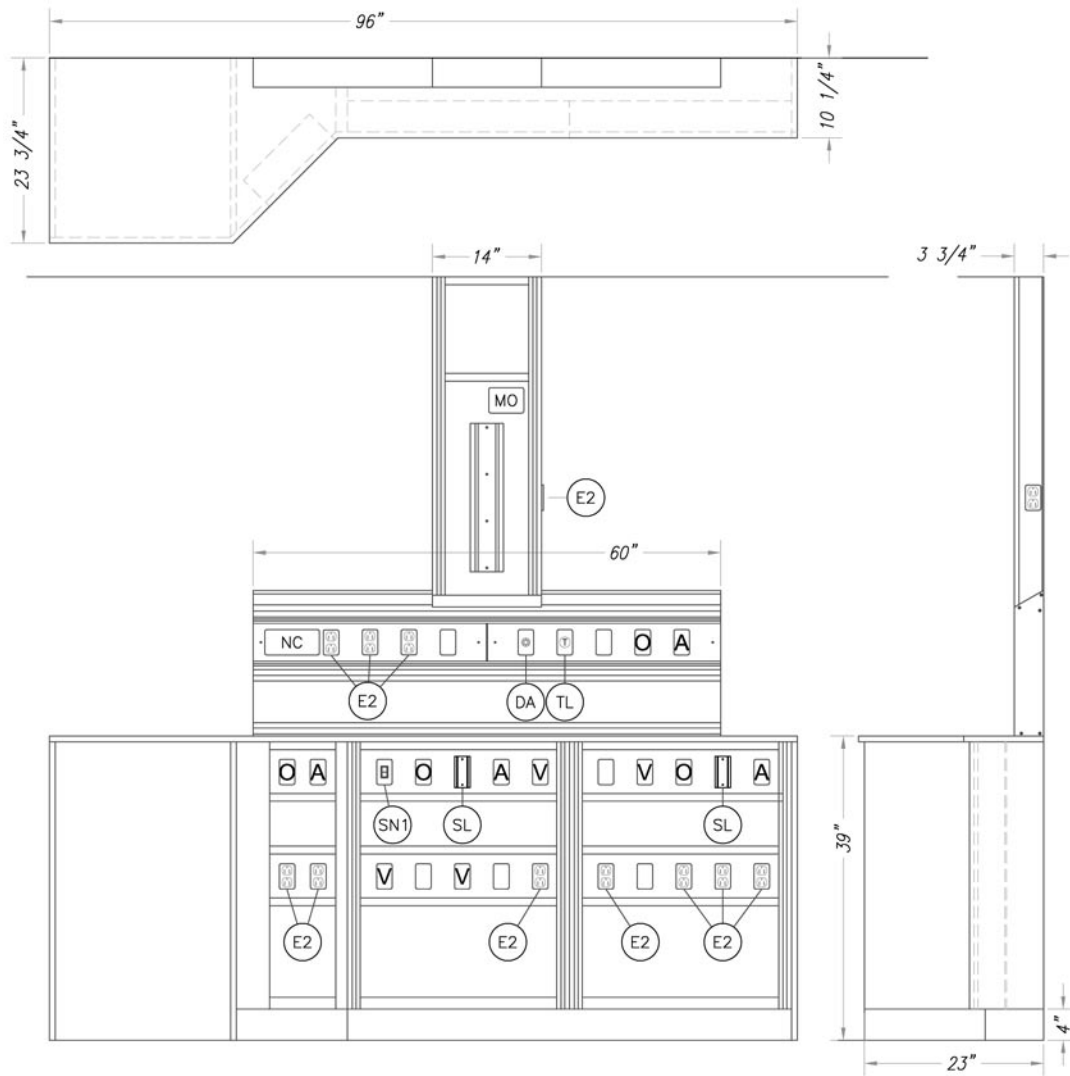

**DISTRIBUTED BY:**