



MEDICAL GAS CHECK VALVE With Extensions

SPECIFICATIONS:

The Medical Gas Check Valve shall be an Amico **Alert-1** series.

The check valve body shall be made of bronze. It shall have a positive shut-off with a self-aligning spring loaded plunger which shall mate with a soft seat.

The valve shall have a straight through design, for minimum pressure drop.

The check valve shall be vibration free and fast acting for silent operation.

Valves shall be equipped with type "K" washed and degreased copper pipe stub extensions at both the inlet and outlet sides of the valve port to facilitate installation.

Each valve assembly shall be washed and degreased for medical gas service. Pipe stub extensions shall be capped at both ends. The valve shall be supplied in a sealed plastic bag to prevent contamination prior to installation.

Amico products comply with NFPA-99.



FEATURES:

- Cleaned for medical gas service
- Individually packaged and capped
- Low pressure drop
- Positive seal and silent operation
- Spring loaded (for vertical mounting)
- 1/2" to 3" size available
- check valve rated at 400 psig [2,758 kPa]
- 100% Hydrostatic tested
- 1/8" dual gauge ports

PROJECT:

DIMENSIONS

A Series
ALERT-1

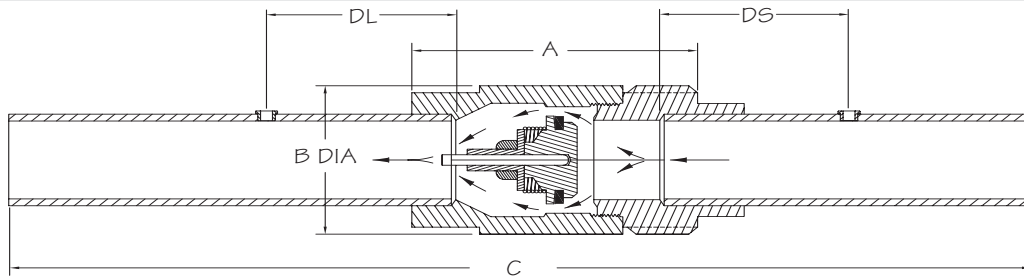

1/2" to 2" Check Valves

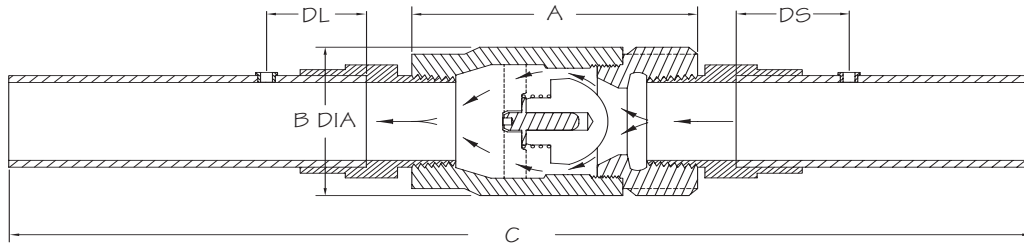

2 1/2" to 3" Check Valves

ORDERING INFORMATION

Units of measure: inch [mm]

MODEL #	VV-CHK-EXT05	VV-CHK-EXT07	VV-CHK-EXT10	VV-CHK-EXT12	VV-CHK-EXT15	VV-CHK-EXT20	VV-CHK-EXT25	VV-CHK-EXT30
SIZE	1/2" [12.7]	3/4" [19]	1" [25.4]	1-1/4" [41.7]	1-1/2" [38.1]	2" [50.8]	2-1/2" [63.5]	3" [76.2]
A	2-5/16" [58.7]	2-7/8" [73]	3-1/2" [88.9]	4-3/16" [106.4]	4-15/16" [125.4]	6" [152.4]	7" [177.8]	8-1/8" [206.4]
B DIA	1-1/8" [28.6]	1-1/2" [38.1]	1-15/16" [49.2]	2-1/2" [63.5]	3" [76.2]	3-3/4" [95.25]	4-1/2" [114.3]	5-1/4" [133.3]
C	22-7/8" [555.6]	22" [558.8]	22" [558.8]	23-1/4" [590.5]	23-1/4" [590.5]	21-7/8" [555.6]	32-1/4" [819.2]	34-1/4" [870.0]
CV	6	12	25	44	65	120	175	265
DS (SHORT)	3-11/16" [85.7]	3-11/16" [85.7]	3-1/8" [79.4]	2-11/16" [68.3]	2-11/16" [68.3]	2-11/16" [68.3]	2-3/8" [60.3]	2-11/16" [68.3]
DL (LONG)	3-7/8" [98.4]	3-7/8" [98.4]	3-7/8" [98.4]	4" [101.6]	4" [101.6]	2-11/16" [68.3]	2-3/8" [60.3]	2-11/16" [68.3]

* The CV is defined as the US Gallons of water per minute that the valve will pass with a 1 Psi pressure drop.

DISTRIBUTED BY: