



Installation Instructions

regal series
surface mount flatwall



Before Installation

note

Flatwall installation should conform to local building codes

1 Review a copy of the final approved shop drawing(s) and/or submittal package. These documents will provide you with technical information specific to your installation, such as:

- equipment types & quantities
- room numbers and location
- shop drawings of each unit type
- wiring diagrams and rough-in locations

2 Locate the flatwall unit from the shipping boxes that you wish to install. The contents of each shipping box are listed on the shipping document(s).

- 1 Remove laminate panels from flatwall (using tool provided) by lifting panels vertically until resistance is felt, then rotate bottom of panel out and pull down. Be careful not to drop panel.



tool provided:
suction cup

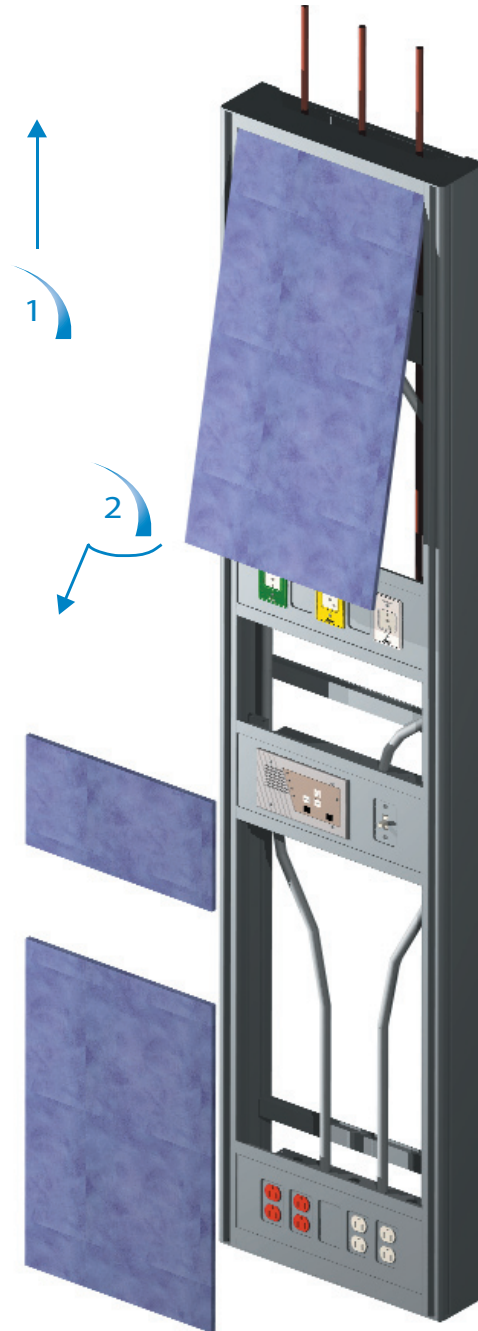

- 2 Mark horizontal line 7" below finished ceiling line. This line will be used to locate drilling for mounting of hanging bracket.

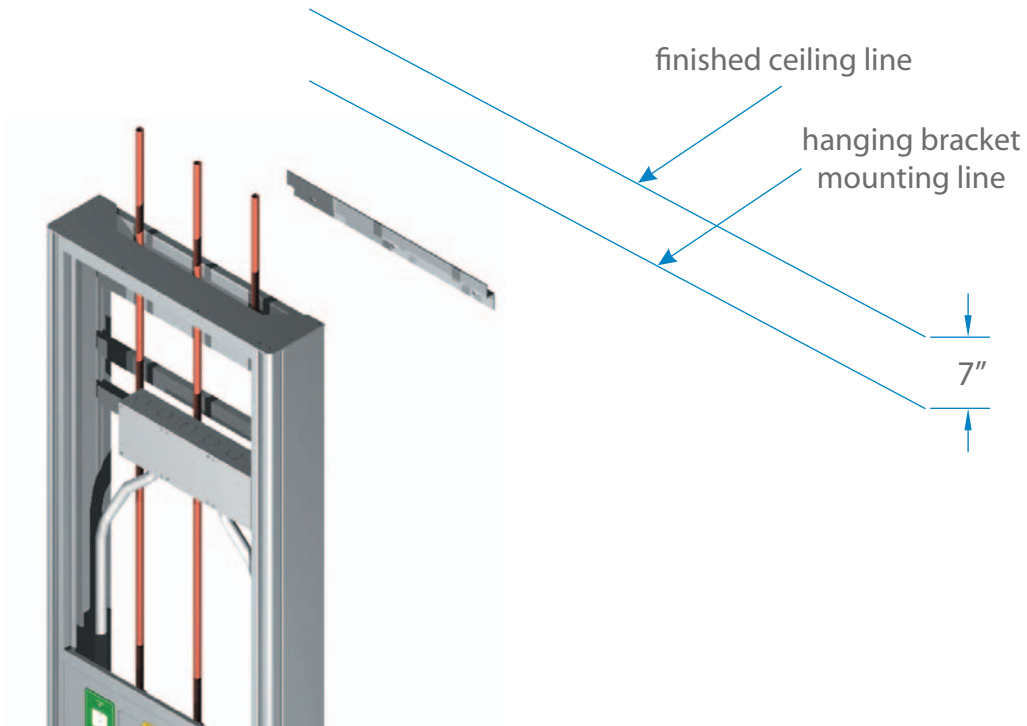

- 3 Align bracket horizontally according to flatwall mounting location. Refer to drawings. Mount the bracket on the wall using hardware compliant to local building codes (supplied by others). Use mounting line from step 2 to locate mounting holes vertically. Ensure hanging bracket is secured to wall studs.

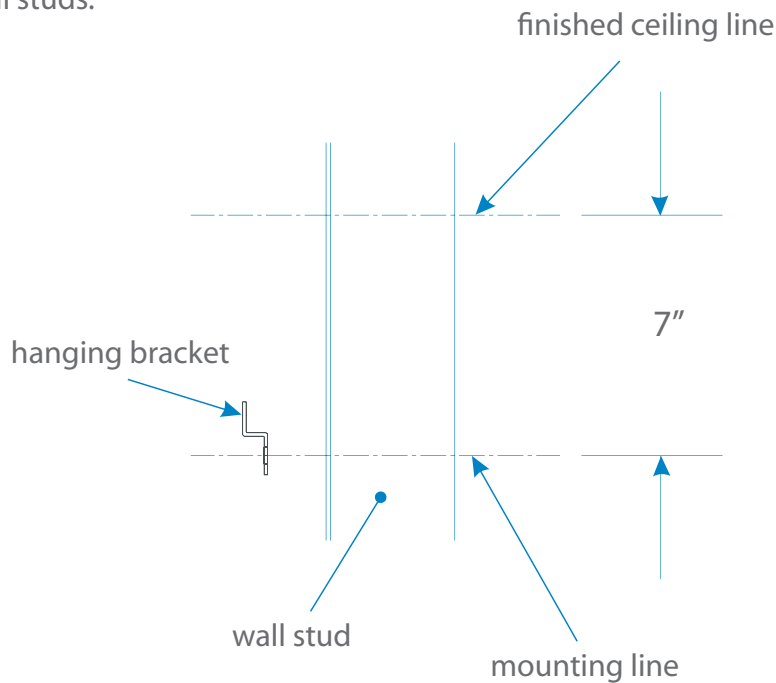

- 4 Hang the unit over the hanging bracket. Secure the unit through lower rear bracket to wall. Ensure hanging bracket is secured to wall studs. Use similar hardware as previously used to secure hanging bracket.

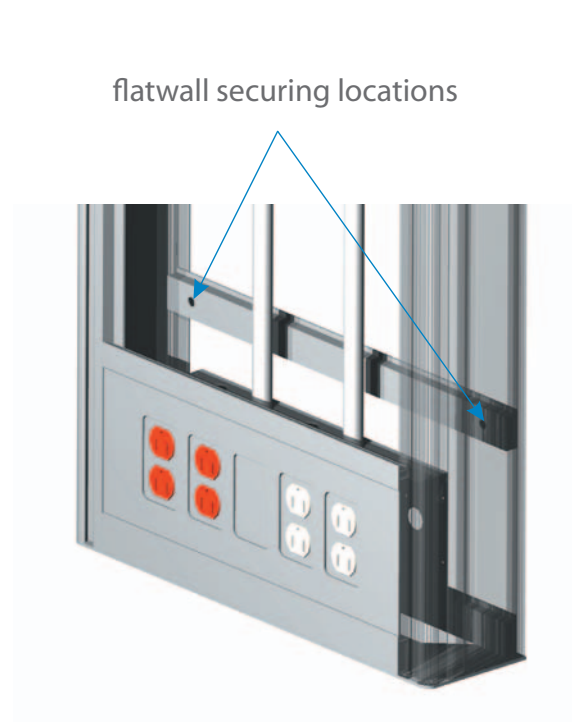
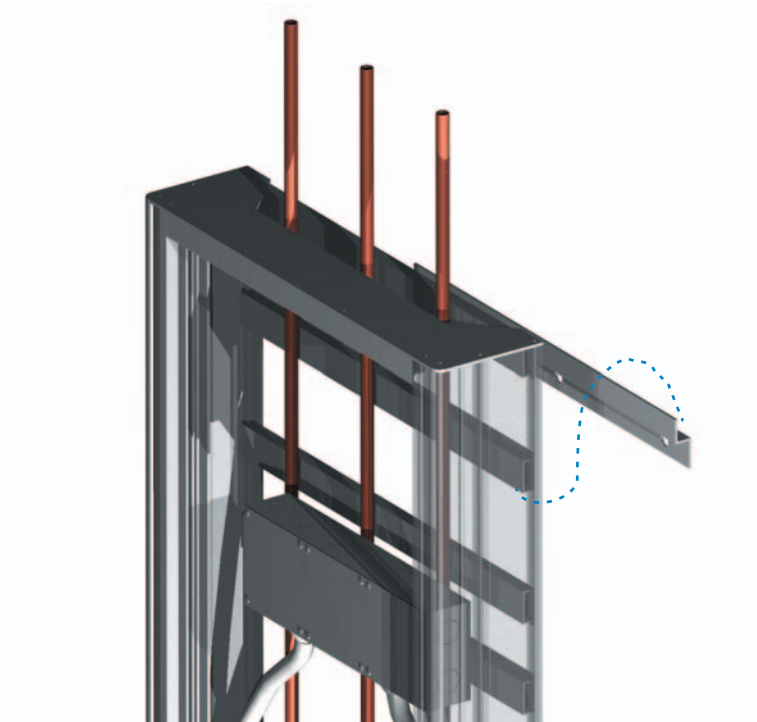

- 5 Make all electrical and piping connections. Electrical services are terminated at junction boxes. Medical gas pipes are terminated as per shop drawings.

- 6 Replace laminate panels removed in [step 1](#).



85 Fulton Way, Richmond Hill
Ontario, L4B 2N4, Canada

14 Madison Road, Fairfield
NJ 07004, USA

Toll Free Tel: 1.877.462.6426
Toll Free Fax: 1.866.440.4986
Tel: 905.764.0800 | Fax: 905.764.0862
www.amico.com

